

Rover

Assembly
Guide

pedestal®

Congrats on your new Pedestal product, and welcome to the world of Pedestal. You have entered a colorful world of design items made for you to elevate your interior design.

Deeply rooted in the Scandinavian design tradition, our products reflect our commitment to quality, functionality and simplicity.

Let’s go on a more colorful journey together - where form follows function playfully!

/Pedestal

Parts

Assembly kit – Step 1

Putting your Pedestal together.

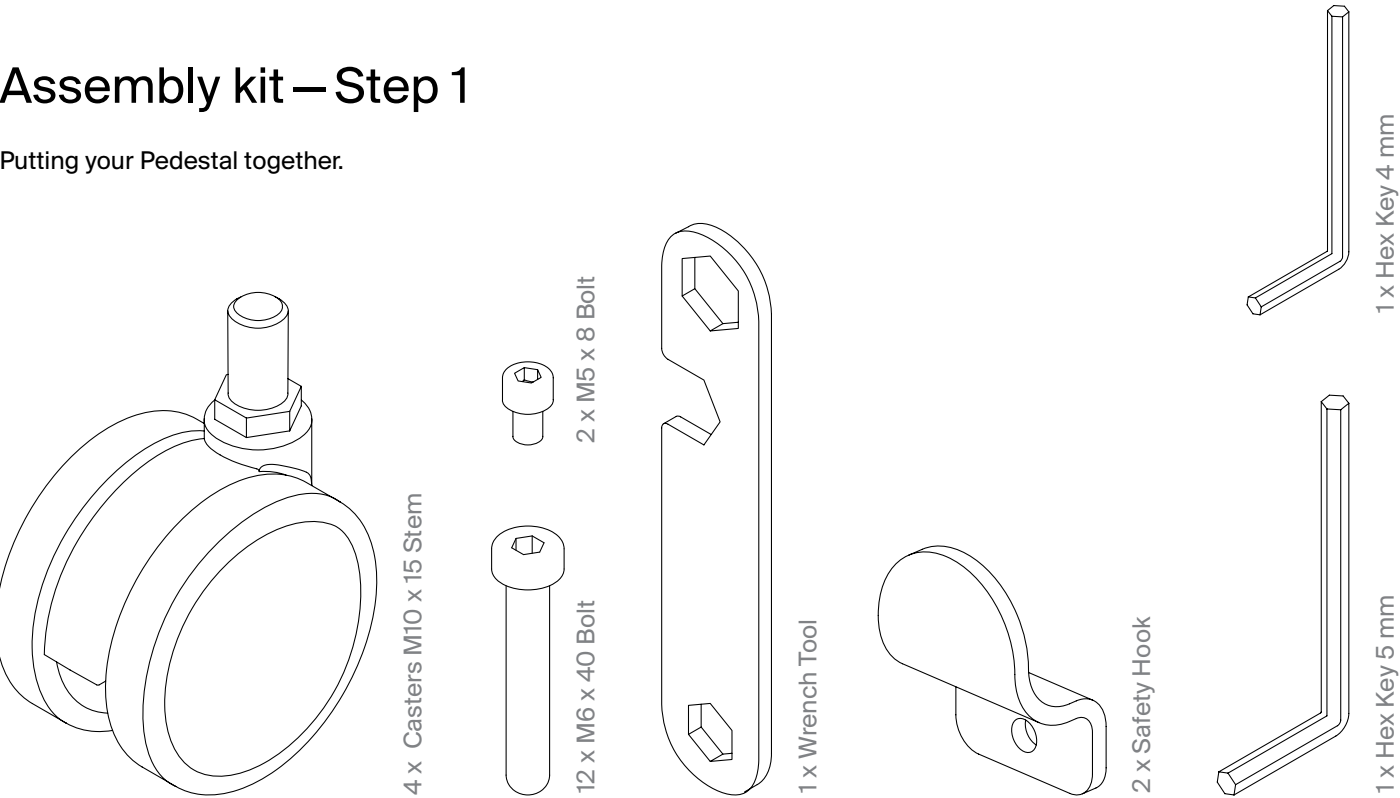

VESA-Kit – Step 2

Mounting your screen.

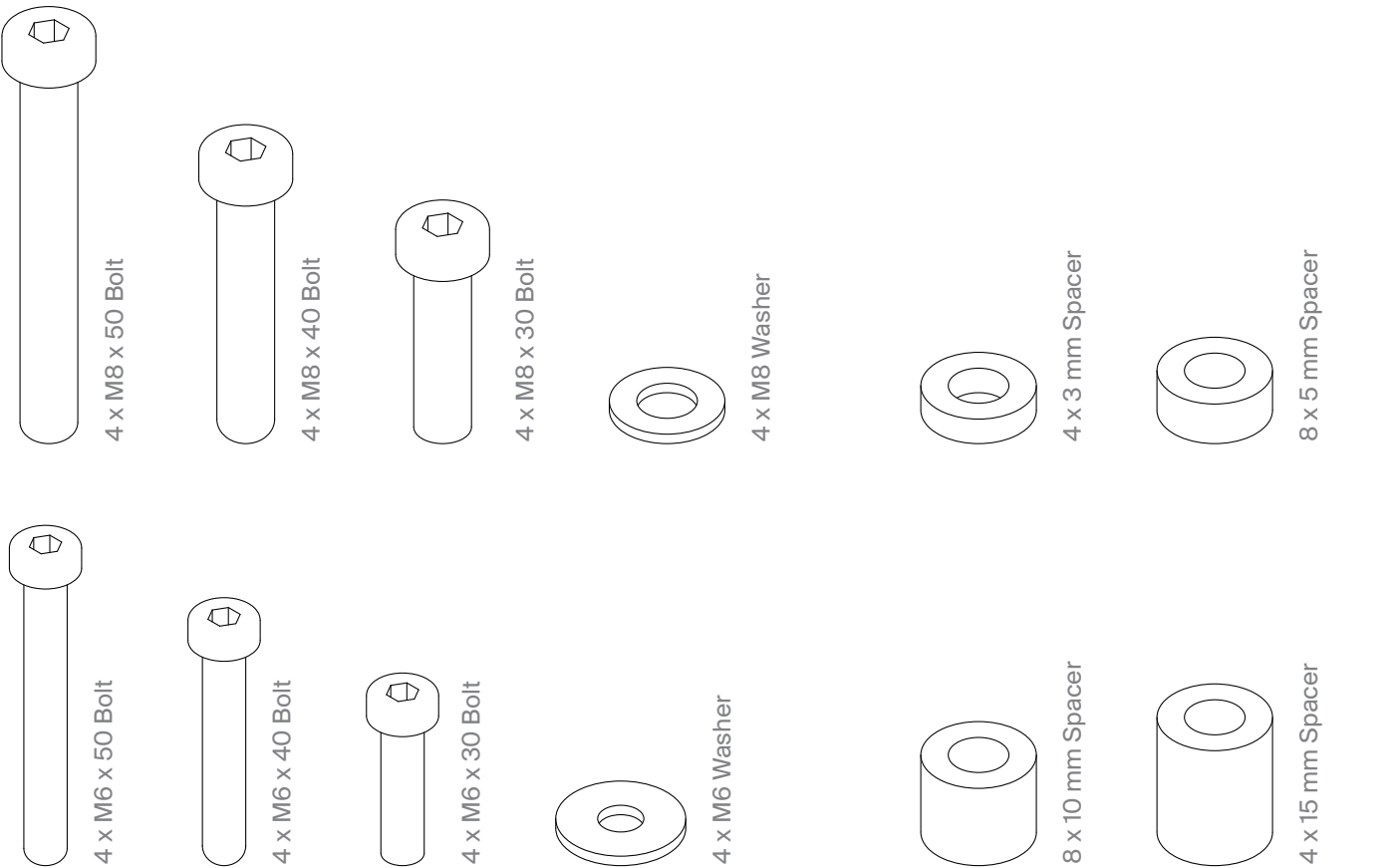

Rover is designed by Pedestal ApS.
Ib Spang Olsens Gade 12, 8200 Aarhus N, Denmark.

Copyright © Pedestal ApS - All rights reserved.

Scan the QR code to access all our guides or get in touch at pedestal.com

1.0 Mount the shelf

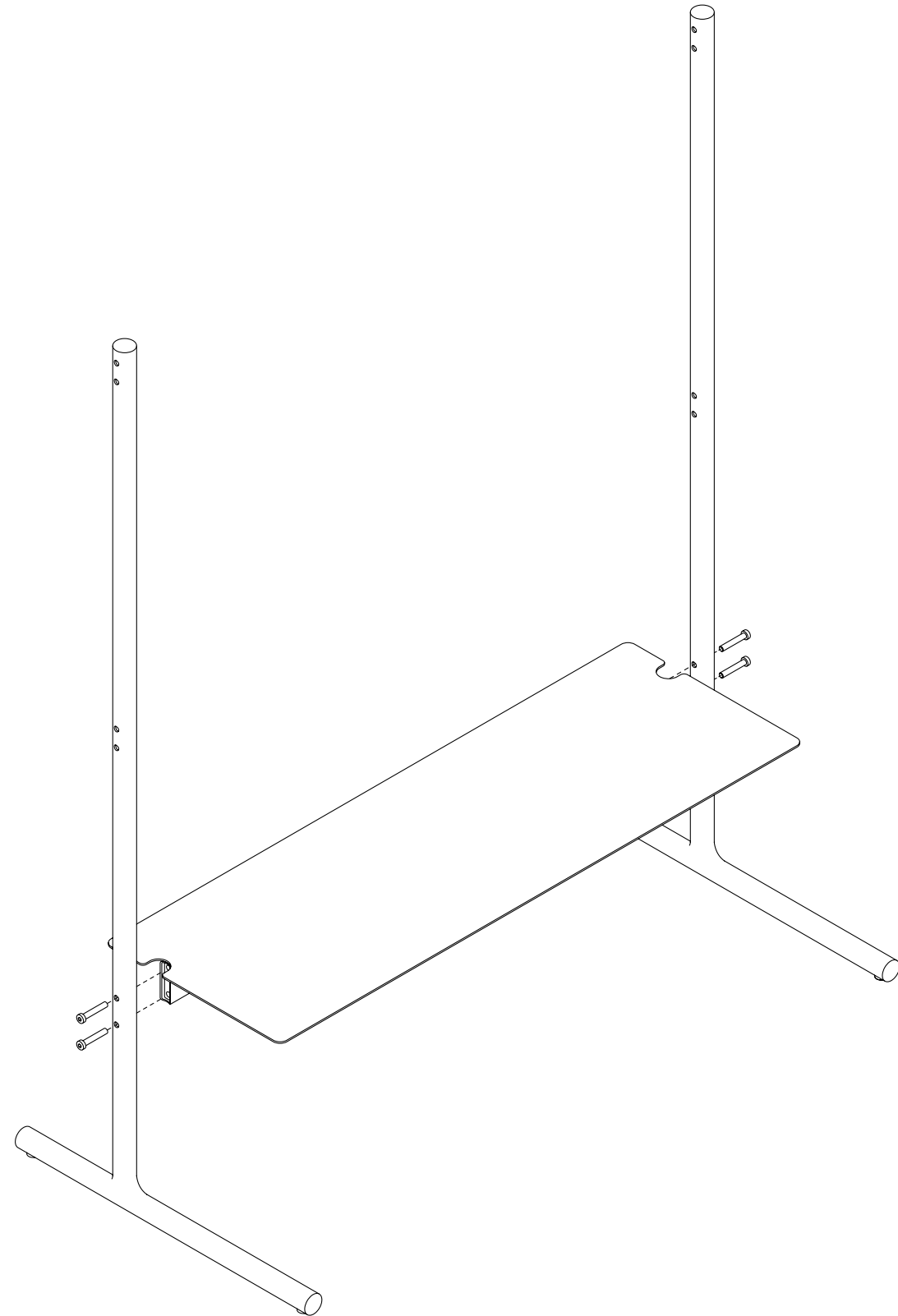

Task

Loosely attach the legs to the shelf using the bolts provided in the bag marked STEP 1. Just use your fingers - no need for tools yet.

Parts

4 x M6 x 40mm bolt

Hot tip!

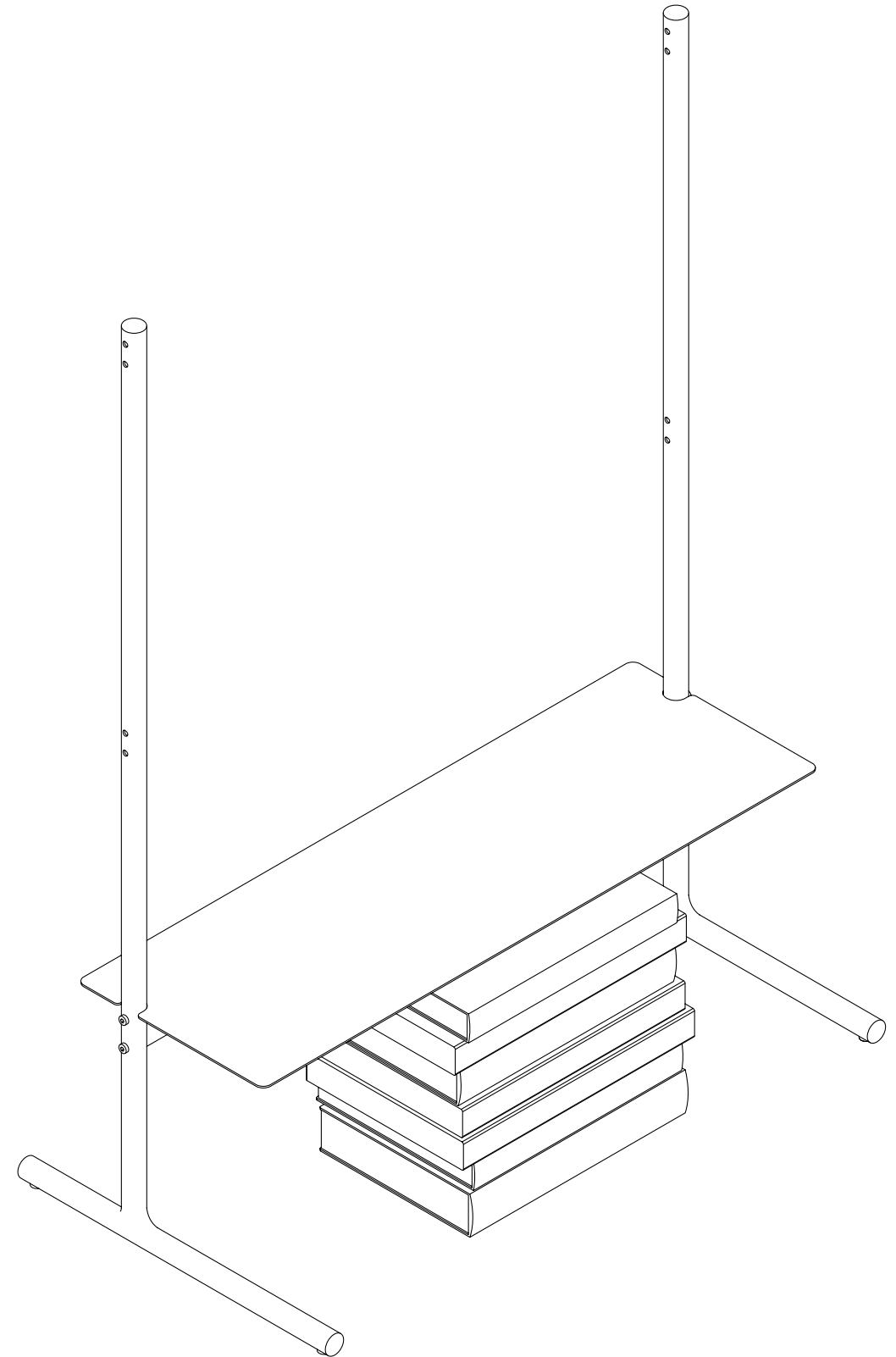

Task

To keep things level and your hands free, grab a sturdy box or that stack of cookbooks you always knew would come in handy. Trust us, it makes assembly a whole lot easier.

Parts

A stable box or any flat, solid object that can support the shelf.

2.0 Mount the brackets

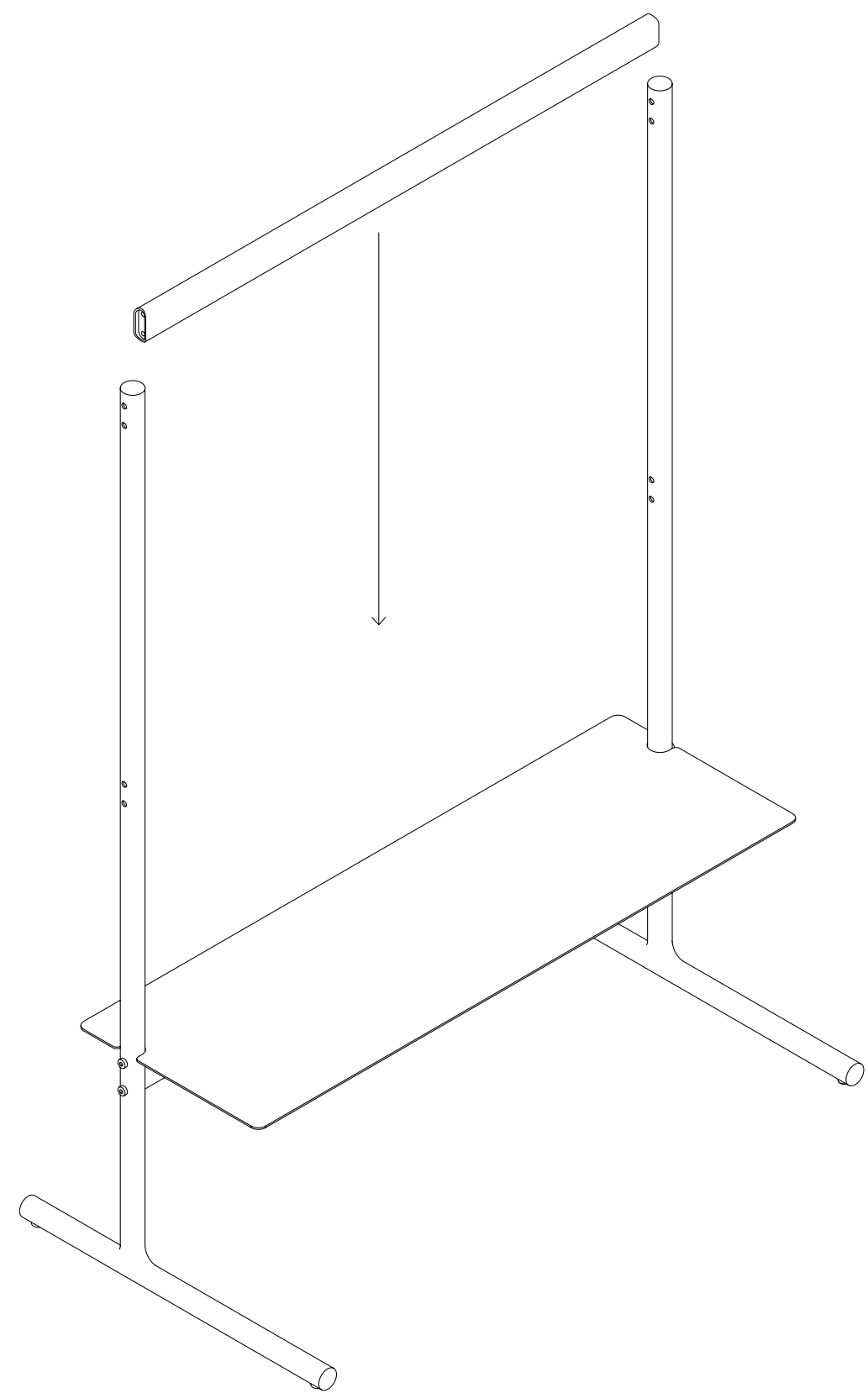

Task

Carefully slide the crossbar into place.
Align the holes in the brackets with the threaded holes in the crossbar.

2.1 Attach the first bracket

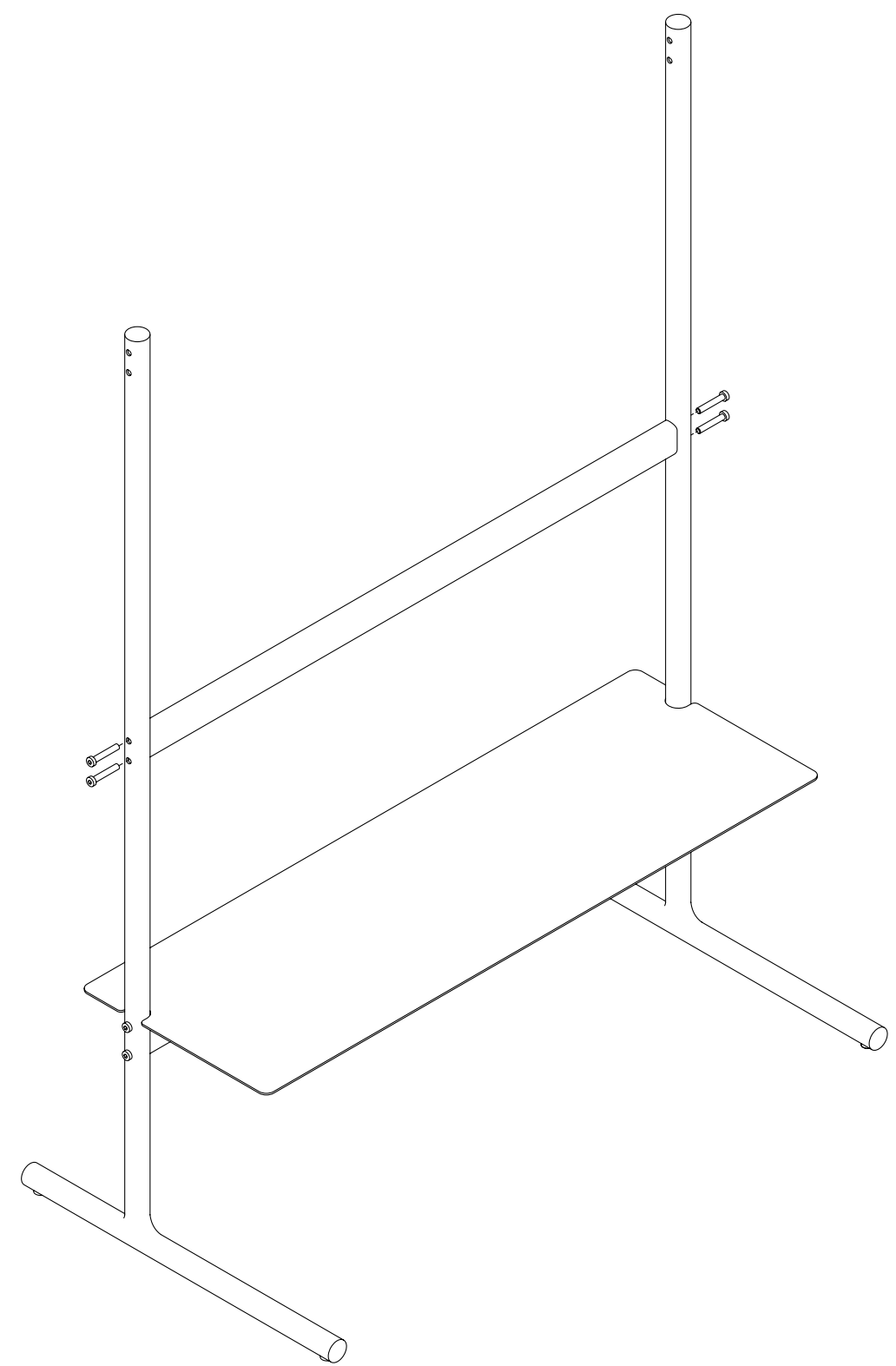

Task

Using the same bolts and technique as you did with the shelf, loosely attach the first bracket.
We're still in the rough-fit stage, so use your fingers and keep those tools tucked away for now.

Parts

4 × M6 x 40mm bolt

2.2 Attach the second bracket

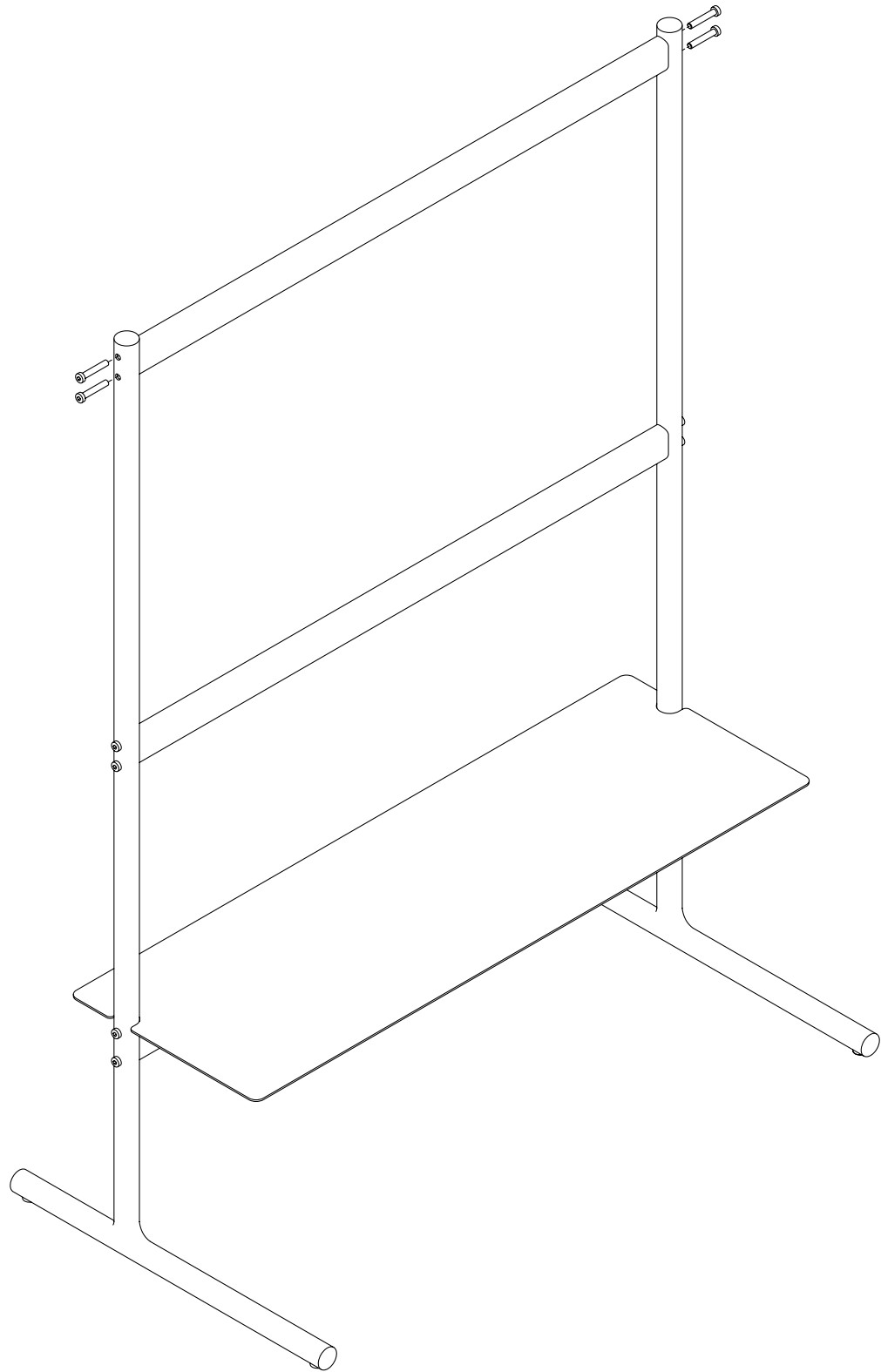

Well done!

Let's get this thing rolllin'!

Task

Now mount the second bracket, just like the first.
Once it's in place, go ahead and tighten all the bracket bolts using the smaller hex key

Parts

4 × M6 x 40mm bolt

3.0 Prepare to mount the wheels

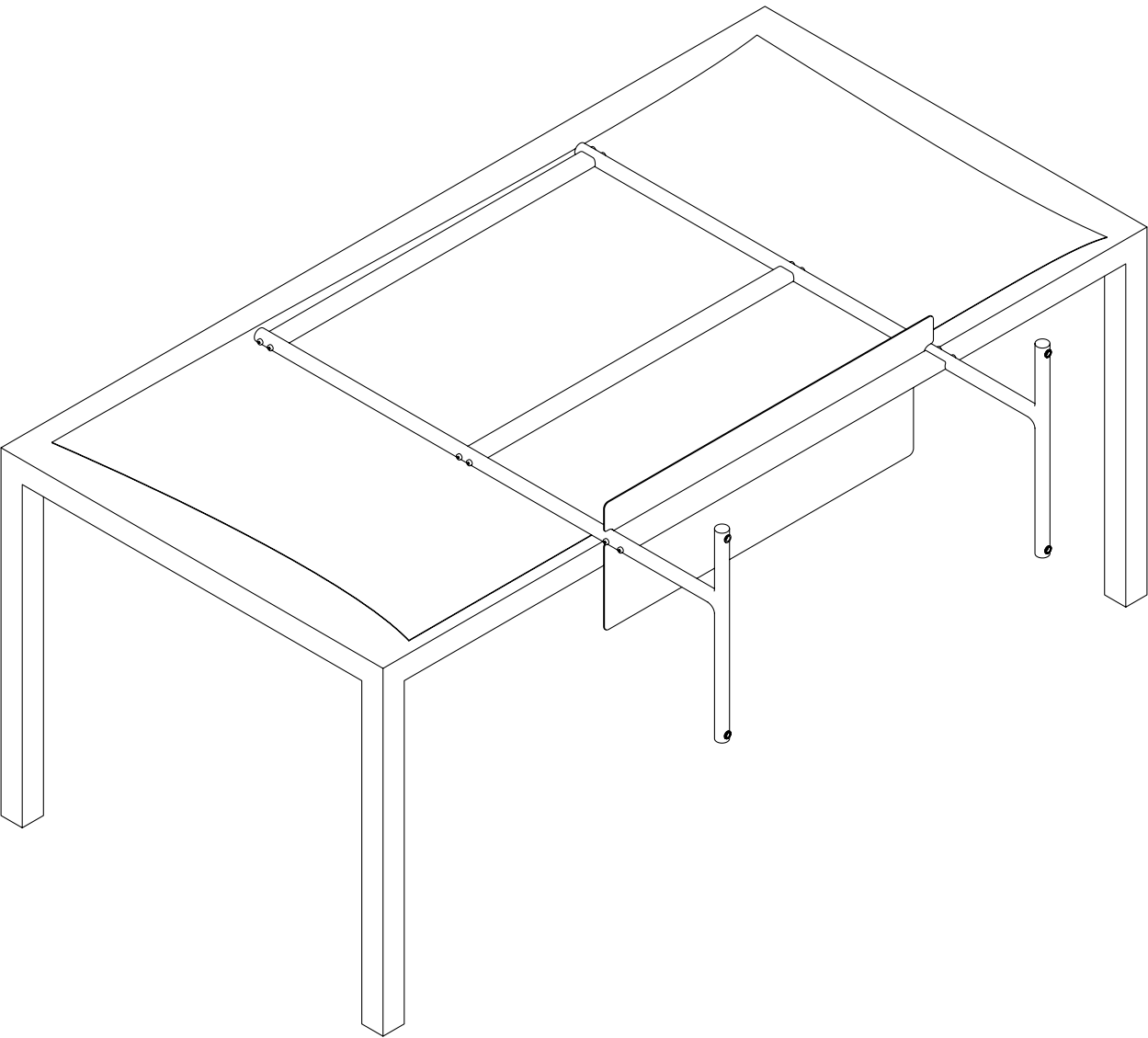

Task

Gently flip the stand and place it on a table.
Slide a soft blanket or cloth between the two to protect both surfaces
and avoid any unnecessary battle scars

3.1 Mount the wheels

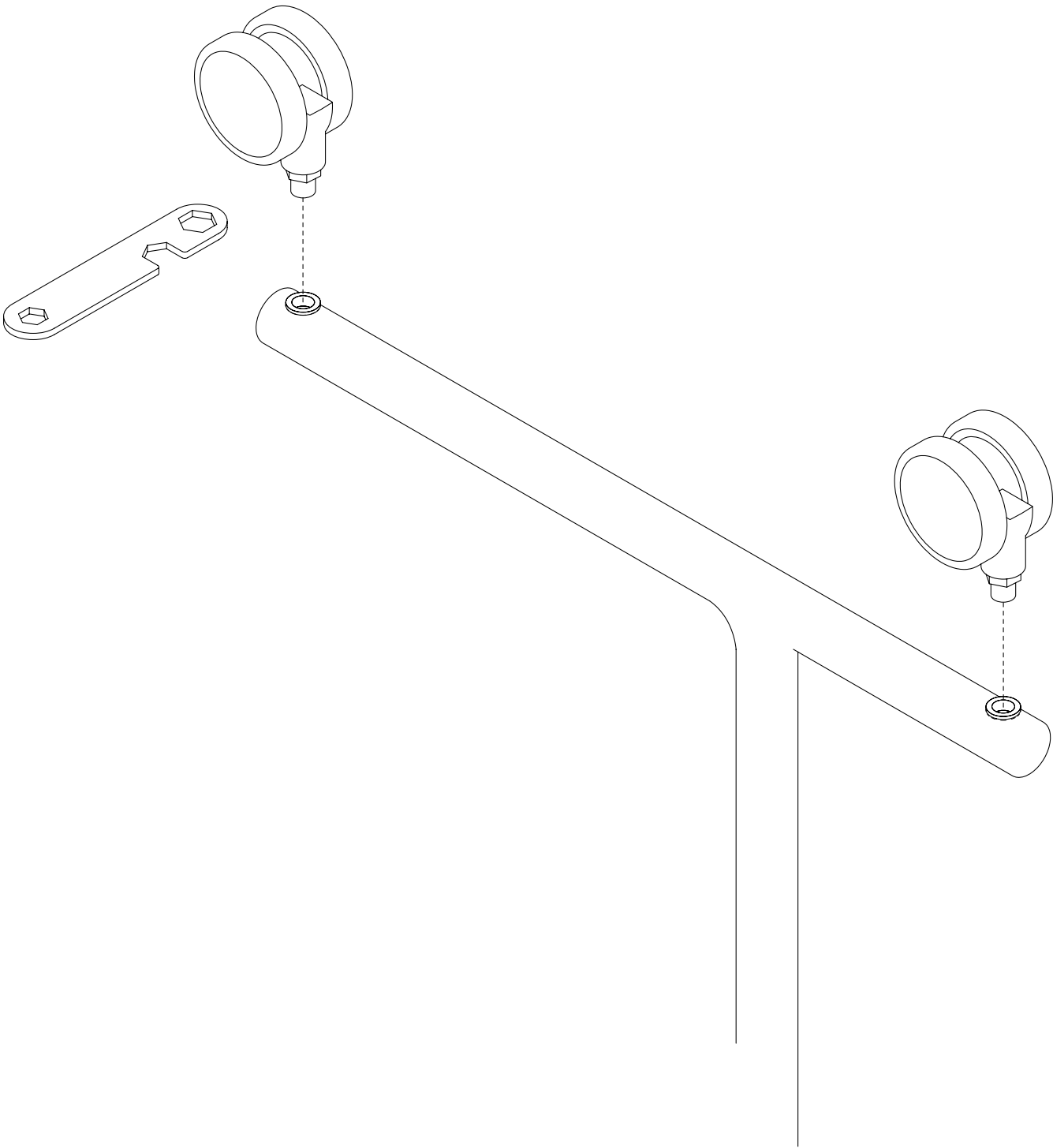

Task

Attach all four wheels using the open side of the wrench tool.

Parts

4 x Casters

You're doing great!

We're ready to mount your screen.

4.0 Mount TV Brackets

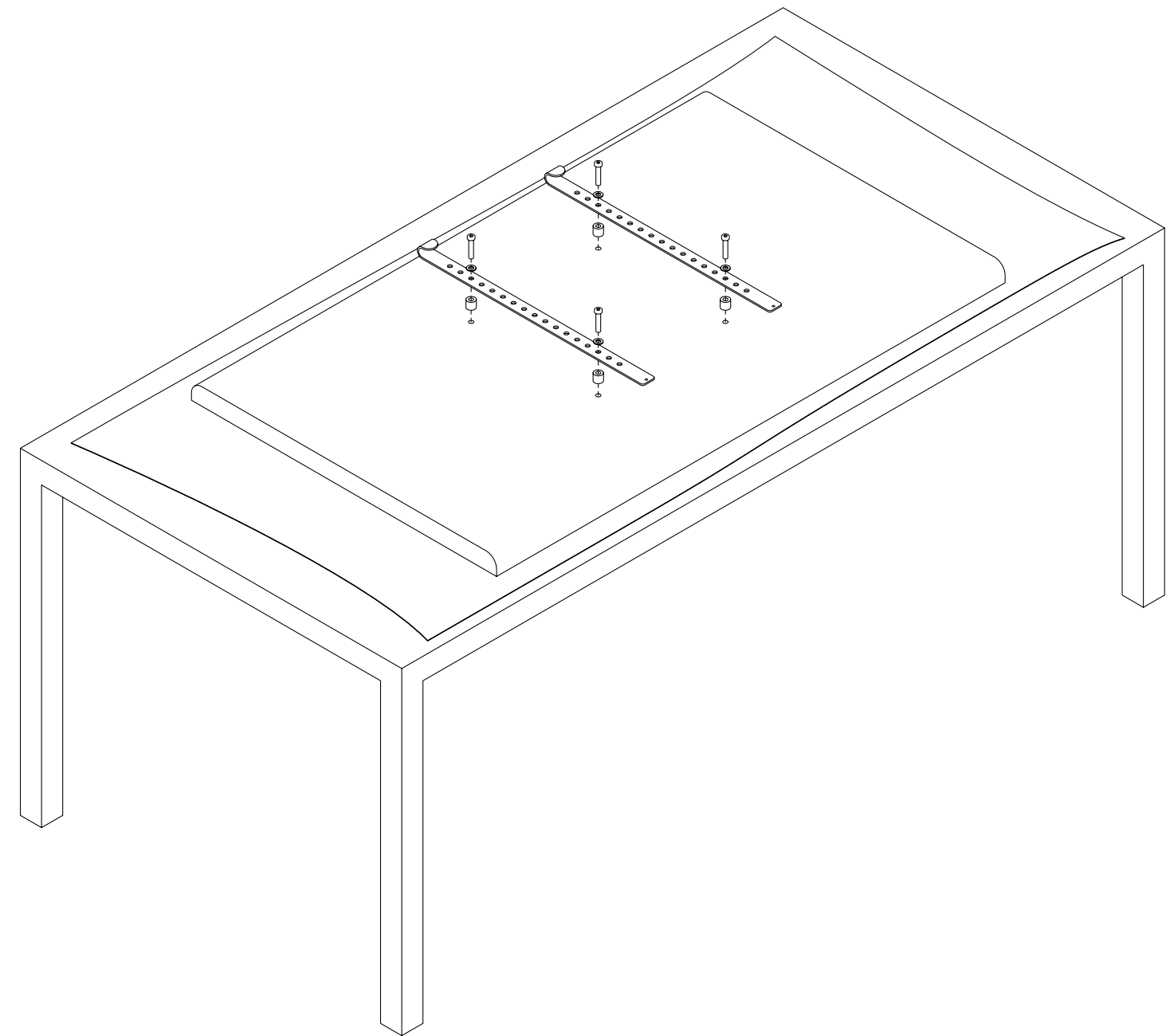

Task

Place your screen face-down on a soft surface like a cloth or blanket to prevent damage.

Mount the brackets vertically using the VESA holes on the back of your TV, with the hardware provided in the bag marked STEP 2.

For help choosing the right hardware, see step 4.1.

Parts

4 x Suitable bolts
4 x M6 or M8 washers
At least 4 x Suitable spacers

4.1 TV brackets fitting

Correct fit

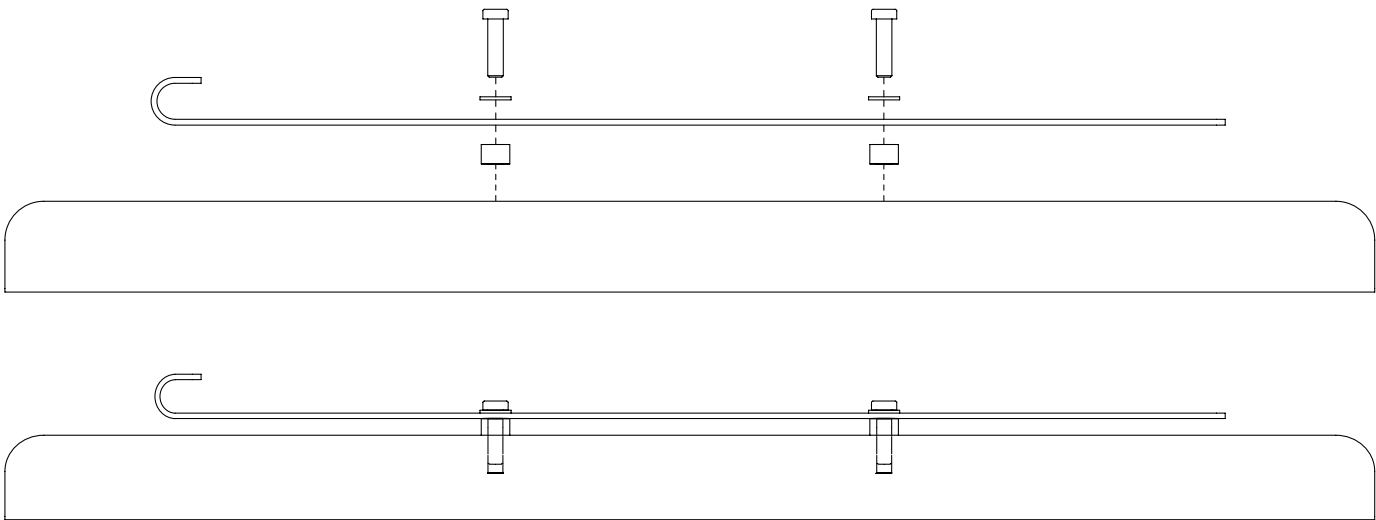

Incorrect fit

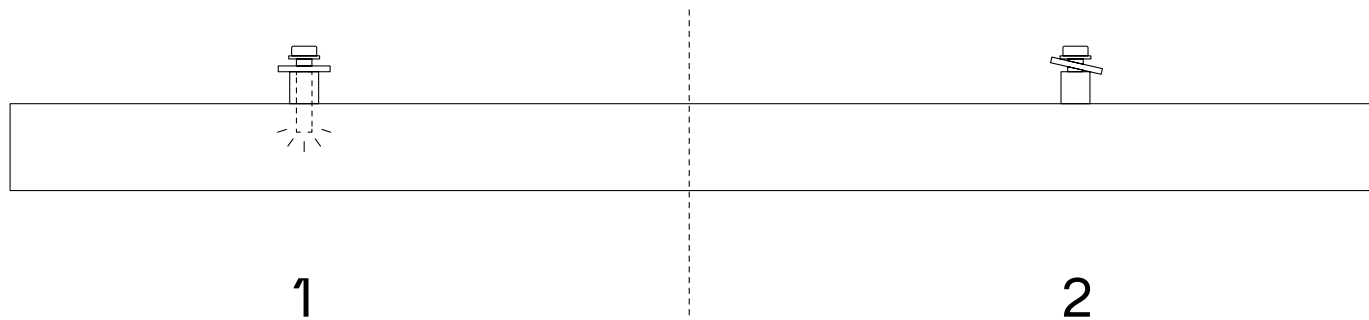

Do not panic!

Don't worry when you see all those bolts, washers, and spacers – you won't need them all. We've included a generous selection to fit as many screen types as possible.

Start by figuring out what fits your screen best. If your screen has a curved back or a bulky center, you may need to stack a few extra spacers so the brackets sit comfortably without touching the screen directly.

Now, thread the correct bolt through a washer, into the bracket, then through any necessary spacers, and finally into the threaded holes on the back of your screen.

Tighten everything until it feels snug – not super tight. The bolts shouldn't reach the bottom of the holes. Give them a confident twist, but don't flex your muscles too much. Overtightening can damage the screen, and we want to keep things in one piece.

Having trouble finding the perfect spacer?

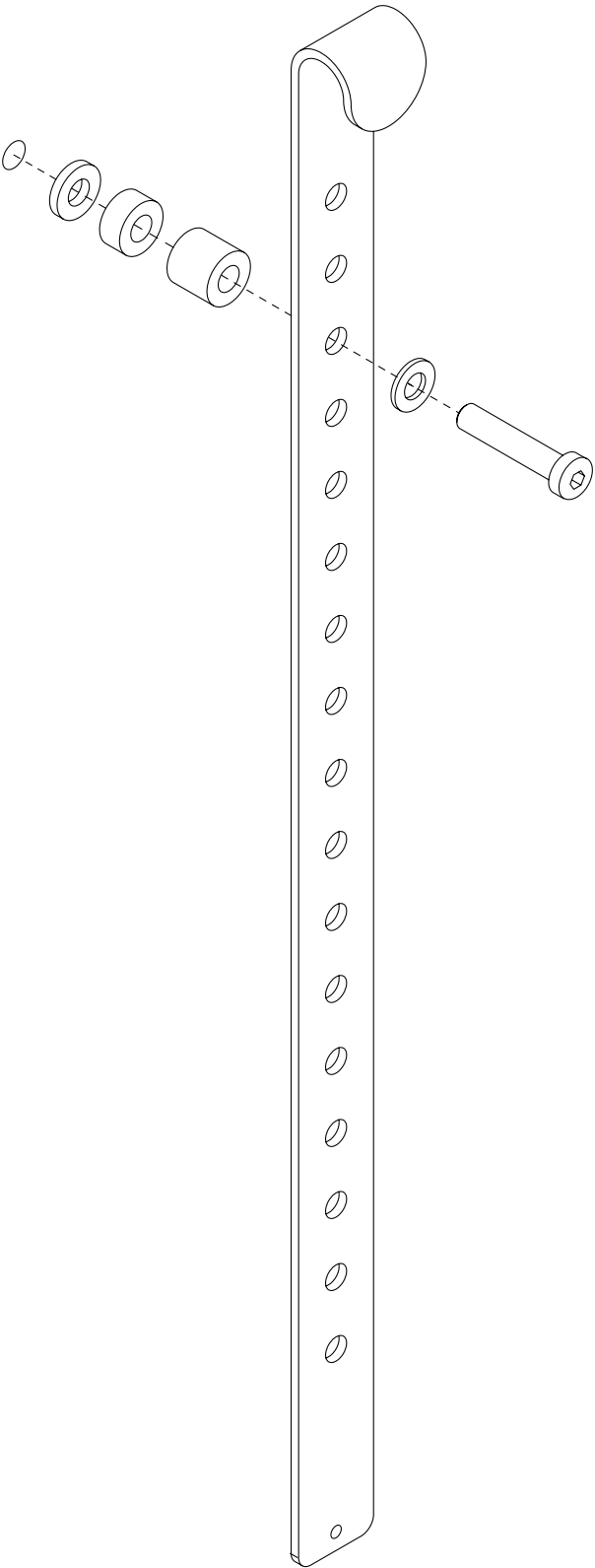

No problem!

Just stack 'em up, mix and match for the perfect fit!

5.0 Mount screen

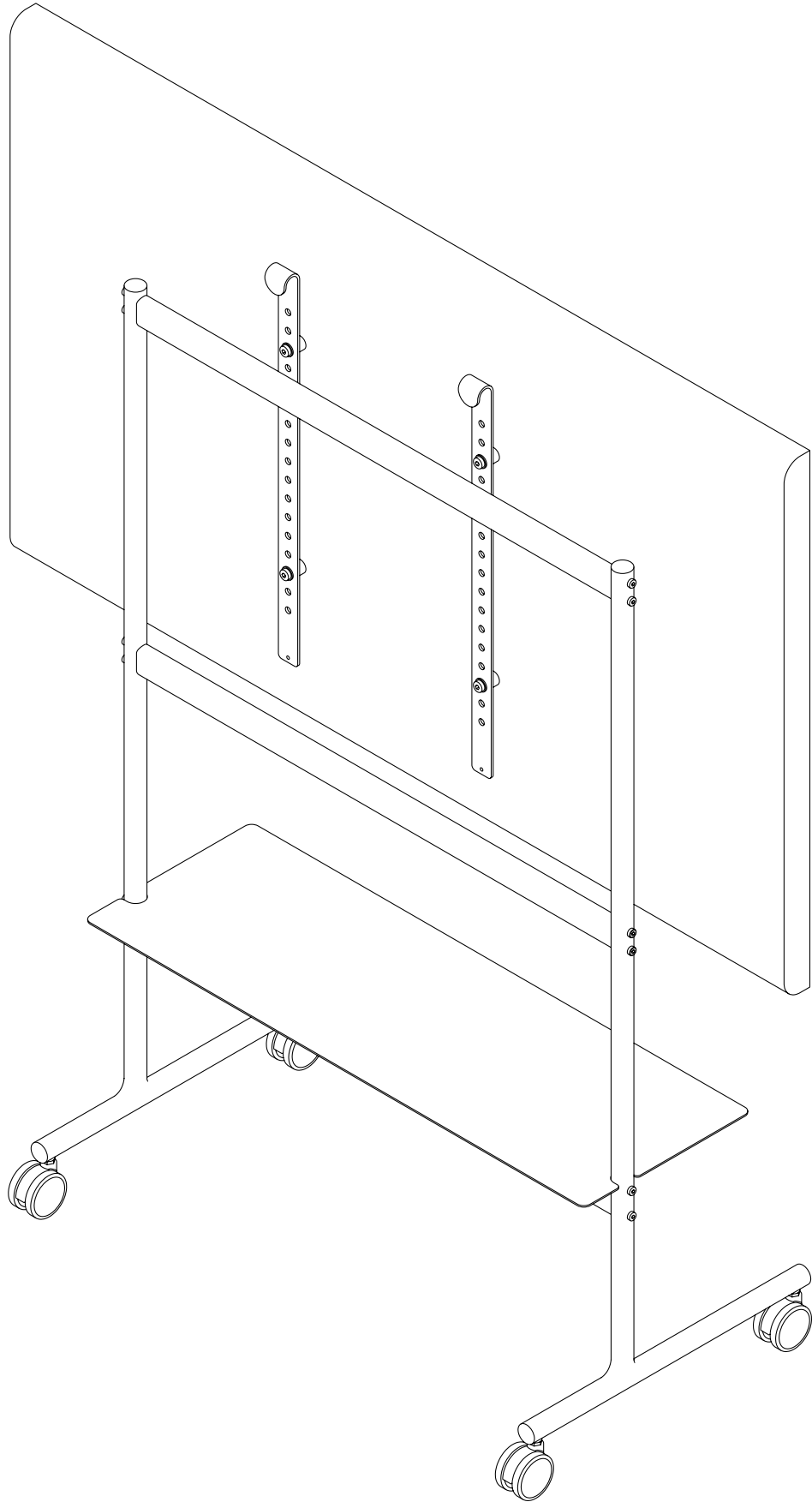

Task

Carefully lift and lower the screen onto the stand.
It helps to have a friend for this step - screens can be heavy and awkward to handle!

6.0 Mount safety hooks

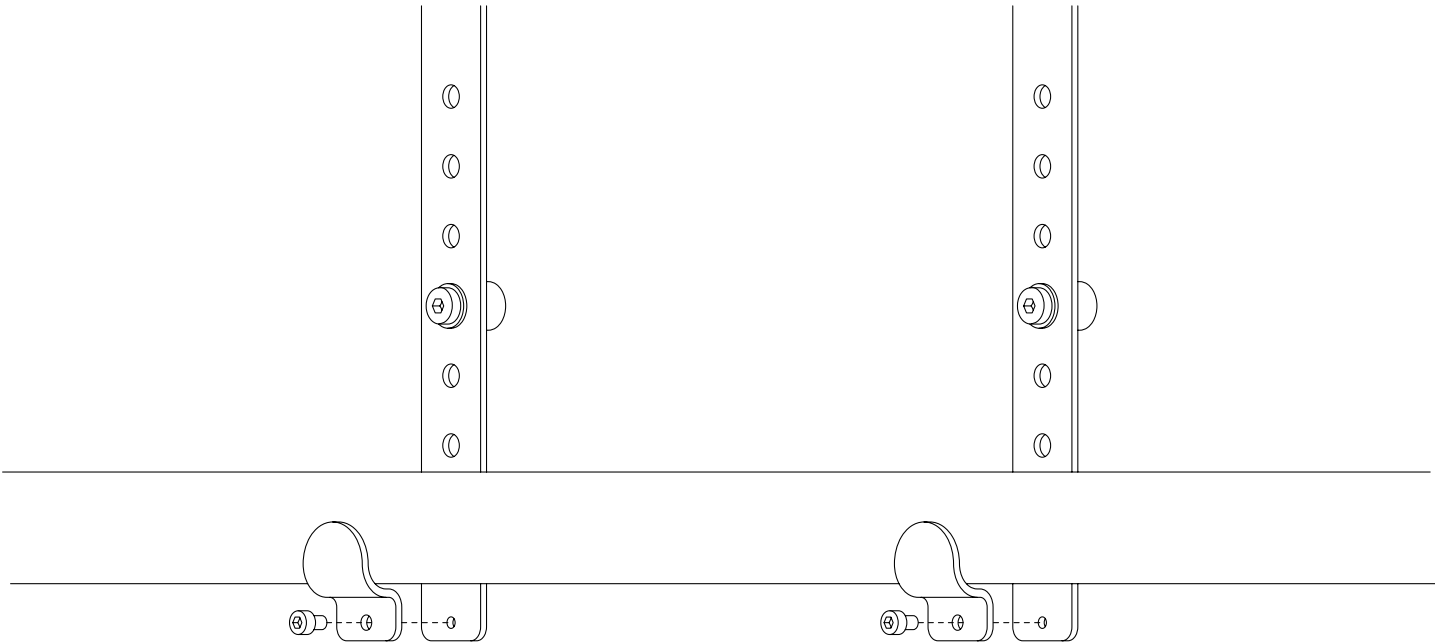

Task

Secure the screen to the stand using the safety hooks.
Tighten all connections to lock everything in place.

Parts

2 x M5x8mm Bolts

All done!

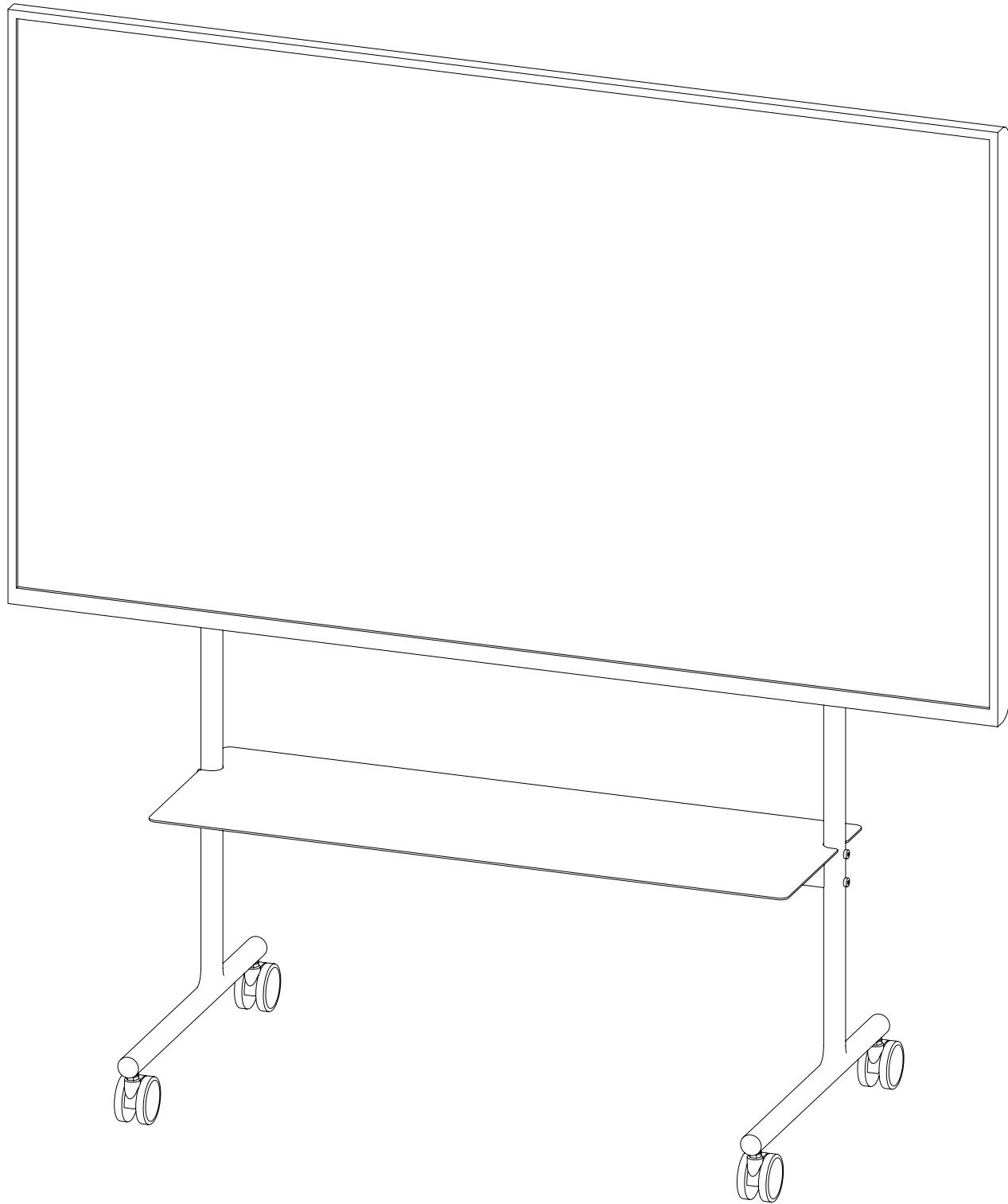

pedestal®

Task

That's it!
Time to connect your cables, grab the remote, and dive into your favorite show. You've earned it.

